

# SKYLIGHT.

59 Złota St., Warsaw

globalworth  
PPP

## ABOUT THE BUILDING.

**23,000 sq m**

TOTAL GLA

**2007**

YEAR OF COMPLETION

**1600**

PARKING PLACES

**1/90**

PARKING PLACE RATIO

**Excellent**

BREEAM CERTIFICATION

Located in 59 Złota St., Skylight is part of Złote Tarasy, a commercial and office complex. Skylight is located in the strict Warsaw's city centre, just opposite Palace of Culture & Science and in close proximity to the Main Railway Station. Thanks to it's prime location, it offers excellent network of public transportation and a great number of amenities.



**8 min** by foot  
Metro Centrum Station

**20 min** by car  
Chopin Airport

**20 min** by foot  
Three Crosses Sq.



Tram stop



Bus stop



Train station



Veturilo

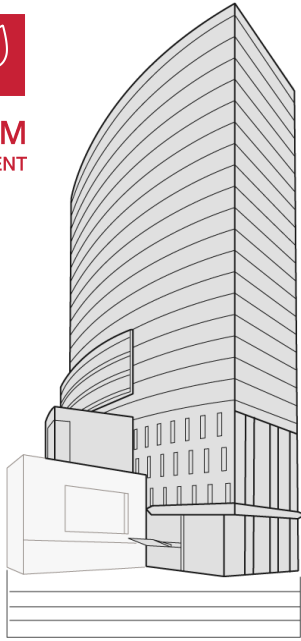

## TYPICAL FLOORPLAN.

0000 sq m

Total leasable area

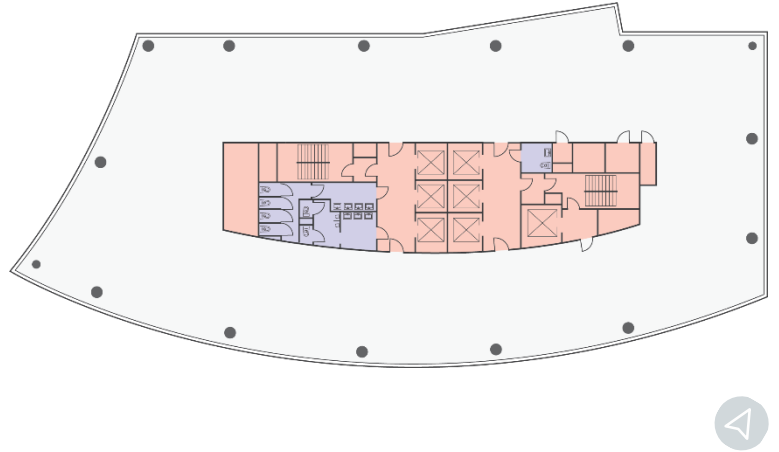

## AMENITIES.

Veturilo station located near the building

Showers and parking spaces for cyclists

The building is connected to the shopping center Złote Tarasy

## TECHNICAL SPECIFICATION.

BREEAM certificate – Excellent

Reception

Access control

Security

BMS

Fiber optics

Emergency power supply

Air conditioning

Raised floors

Suspended ceilings

Power cabling

Sprinklers

Smoke detectors

Carpeting

Wall partitioning

Disclaimer: This document is for information purposes only and do not constitute any part of a binding offer or contract.



**Anna Korwin-Kulesza**

Asset Management & Leasing Director

M: +48 695 101 598

E: anna.korwin-kulesza@globalworth.pl



**Agnieszka Głuchowska**

Asset Management & Leasing Manager

M: +48 664 739 237

E: agnieszka.gluchovska@globalworth.pl